

Jewish Community Center

# Staenberg Family Complex

## Arts & Education Building

2 Millstone Campus Drive  
St. Louis, MO 63146

[jccstl.org](http://jccstl.org)

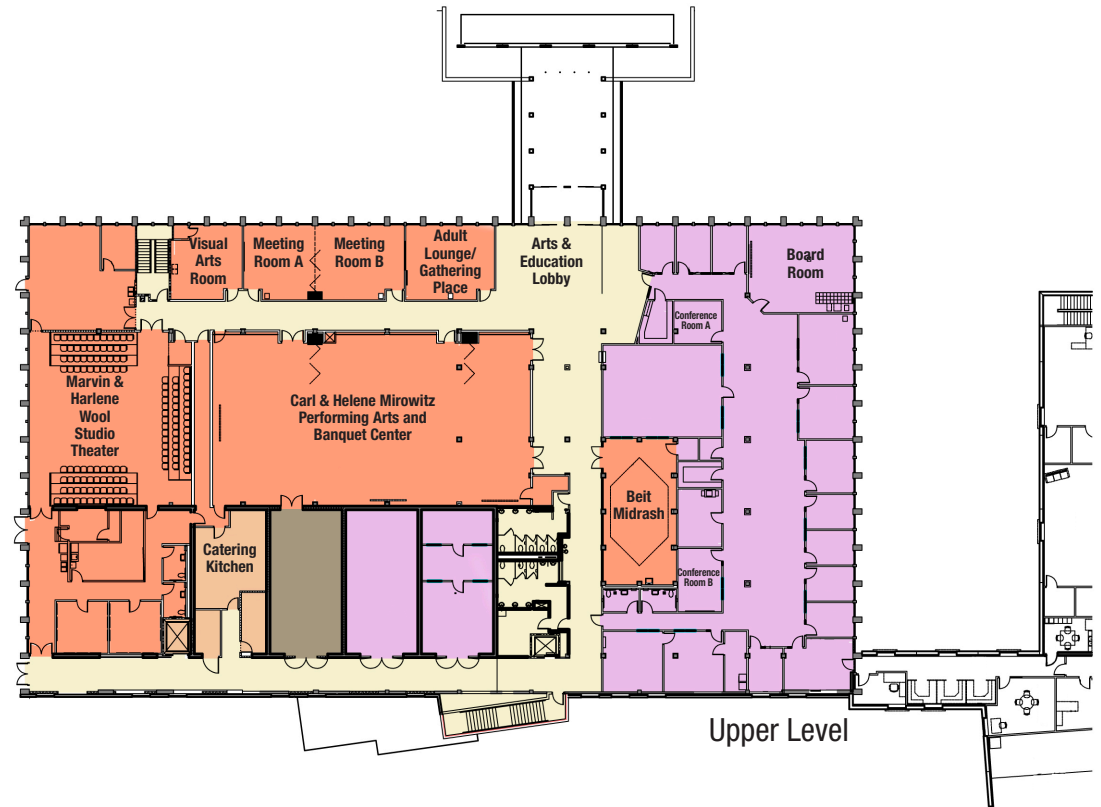

**Isaac Gregg**  
Rental Manager, Buildings & Grounds  
314.442.3427 P/F  
[igregg@jccstl.org](mailto:igregg@jccstl.org)

JEWISH COMMUNITY CENTER



# Staenberg Family Complex - *Arts & Education Building*

St. Louis (near Creve Coeur)

## Conference and Banquet Center

Meeting Space	Dimensions	Ceiling Height	Square Feet	Audience	U-Shape	Class	Hollow Square	Club	Exhibits 8'X10'	Exhibits 10'X10'	Other
Boardroom	29' X 24'	9'	700	-	-	-	20	-	-	-	Available for "boardroom" type meeting setting. Audio-visual equipment available.
Beit Midrash	40' X 20'	15'	800	-	-	-	-	-	-	-	Jewish Learning Center
Mirowitz Performing Arts and Banquet Center	89' X 45'	9' / 19'	4,000	400	-	228	-	300	25	20	Available for formal events-weddings, bar/bat mitzvahs, lock-ins, large parties, business meetings, seminars and conferences. Full catering capabilities. Audio-visual equipment available.
Mirowitz Performing Arts & Banquet Center A	18' X 45'	9'	810	50	20	30	12	30	-	-	-
Mirowitz Performing Arts & Banquet Center B	42' X 45'	19'	1,890	225	56	105	48	150	11	9	-
Mirowitz Performing Arts & Banquet Center C	29' X 45'	19'	1,305	125	40	70	36	100	-	-	-
Adult Lounge/ Gathering Place	25' X 20'	-	500	-	-	-	-	-	-	-	Lounge and meeting/resources area.
Meeting Room A	20' X 20'	9'	400	45	15	18	10	20	-	-	Room dividers for various size meetings. Voice, sound and data capabilities. Audio-visual equipment available.
Meeting Room B	25' X 20'	9'	500	50	20	25	12	25	-	-	Room dividers for various size meetings. Voice, sound and data capabilities. Audio-visual equipment available.
Wool Studio Theater	48' X 45'	-	2,150	200	-	-	-	-	-	-	125 available seats. Adjustable performance floor for various performance and seating capabilities.
Arts & Education Lobby	41' X 40'	10'	1,620	-	-	-	-	-	10	8	-